



Staging, Seating & Fencing Products



Quality products made in the USA.

2012-09

WARRANTY

Scaffold frames and components, excluding any finishes, casters, and wood products are warranted for five (5) years from date of original purchase.

Carts, excluding any finishes, casters and wheels are warranted for three (3) years from date of original purchase.

Bleacher and staging components excluding any finishes and wood decking are warranted for five (5) years from date of original purchase.

Casters and wheels are warranted for one (1) year from date of original purchase.

Power unit components are warranted for 90 days from date of original purchase. Batteries are warranted for one (1) year prorated.

We will repair, without charge, any defect due to faulty material or workmanship. These warranties do not cover failures due to abuse, misuse, improper installation, accidental damage or when repairs or modifications have been made or attempted to be made by anyone other than Granite Industries. Any defective products that meet warranty specifications and Granite Industries approval, may be returned to the factory to be repaired or replaced free of charge. (Granite Industries will pay to ship replacement item(s) to the customer; however the customer is responsible for shipment of products to the factory.)

This remedy is the sole remedy in contract, tort or otherwise, and Granite Industries is not liable for incidental, consequential or special damages.

These warranties give you specific legal rights, and you may have other rights which vary from state to state. Should you have any questions, contact Granite Industries (Proof of purchase may be required).

Signature
STAGING

pg 4

pg 6

ZDEX

AXIS
STAGING

pg 13

pg 19

pg 24

Table of Contents

STAGING

Signature Staging

Decks	4
Packages	5

ZDex

Decks	6
-------------	---

<i>Dura-Trac Flooring</i>	6
---------------------------------	---

Accessories for Signature Stage & ZDex

Legs, Feet & Braces	7
Build Up Frame	9
Additional Parts	9
Adjustable Stairs	10
Access Ramp	11
Guard Rails	12

<i>Mobile Stage Trailer</i>	12
-----------------------------------	----

Axis Aluminum Staging

Decks	13
Fold X Legs	14
Stairs	15
Guard Rail	15
Additional Parts	15

BLEACHERS & SEATING

Signature Series Bleachers

Deluxe	16
Standard	17

<i>Fold-N-Tow Bleachers</i>	18
-----------------------------------	----

Team Benches	19
--------------------	----

<i>Picnic Tables</i>	20
----------------------------	----

<i>Mobile Scoring Table</i>	20
-----------------------------------	----

FENCING

<i>Crowd Control Fencing</i>	21
------------------------------------	----

<i>Black Tie Fencing</i>	21
--------------------------------	----

CARTS

<i>Multi Mover</i>	22
--------------------------	----

<i>Mantis</i>	23
---------------------	----

<i>Chiavari Chair Cart</i>	23
----------------------------------	----

<i>Stackable Table/Chair Storage Cart</i>	24
---	----

<i>Table Carts</i>	24
--------------------------	----

<i>Platform Carts</i>	24
-----------------------------	----

ALL PRICES ARE SUBJECT TO CHANGE WITHOUT NOTICE.

Signature STAGING



Connecting clips allow for easy installation and enables decks to be offset.



Diagonal angle supports give stage frame additional rigidity and strength.



4x4 Deck with
Quick Connect Brace.

Description	Cat. No	Item No	Weight	Price
4' X 2' Painted Deck	SL24	85025	48 lbs	\$185.00
4' X 4' Painted Deck	SL44	85024	77 lbs	\$210.00
4' x 4' 45° Painted Deck	SLC45	85026	49 lbs	\$210.00
4' X 4' Curved Painted Deck	SLC44R	85292	55 lbs	\$220.00
4' Curved Painted Deck (Left)	SLC4LRD	85294	30 lbs	\$165.00
4' Curved Painted Deck (Right)	SLC4RRD	85295	30 lbs	\$165.00
4' X 2' Carpeted Deck	SL24C	85117	51 lbs	\$265.00
4' X 4' Carpeted Deck	SL44C	85055	73 lbs	\$295.00
4' x 4' 45° Carpeted Deck	SLC45C	85273	52 lbs	\$295.00

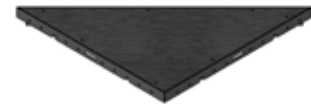

SLC45
4'x4' 45° Corner Deck



SLC4L
4' Curved Deck - Left



SLC4R
4' Curved Deck - Right

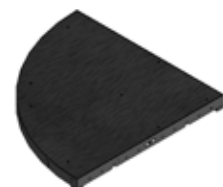

SLC44R
4'x4' Curved Corner Deck

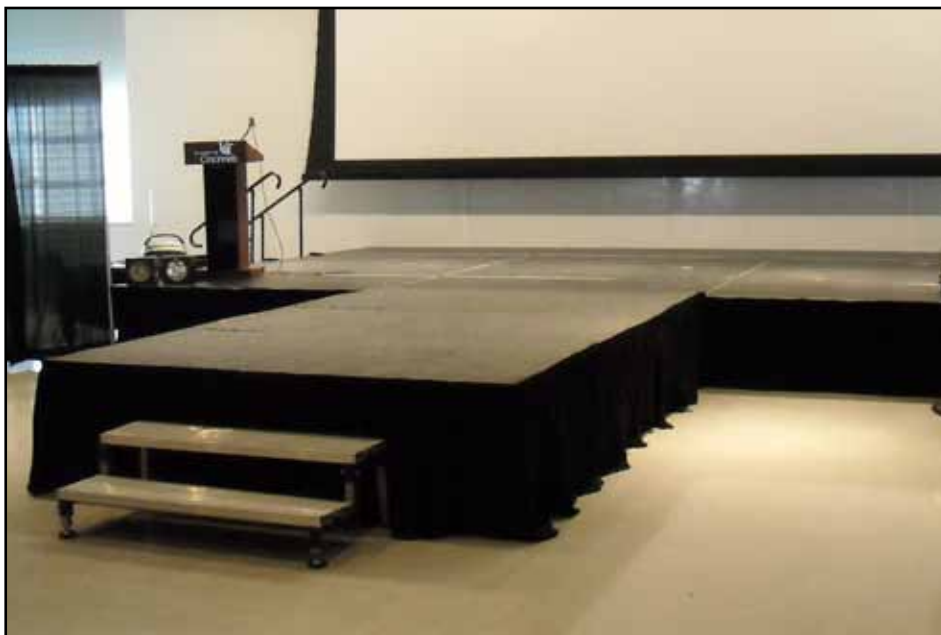

Signature Stage Packages

Stage Size	No of 4'x4' Decks	Starter Package 4" - 30" H**		Additional Deck Heights								Carpet + Price
		Price	Wt	32" - 48"		38" - 54"		26"-44"		32"-56"		
				+ Price	+ Wt	+ Price	+ Wt	+ Price	+ Wt	+ Price	+ Wt	
8'x12'	6	\$1,805.00	560	\$156.60	63	\$269.20	76	\$55.80	30	\$215.80	53	\$270.00
12'x12'	9	\$2,589.00	812	\$220.80	83	\$333.60	101	\$74.40	40	\$262.40	70	\$405.00
12'x16'	12	\$3,505.00	1,108	\$276.00	104	\$512.00	126	\$93.00	50	\$423.00	88	\$540.00
16'x16'	16	\$4,535.00	1,140	\$345.00	130	\$592.50	157	\$116.25	63	\$481.25	110	\$720.00
16'x20'	20	\$5,659.00	1,790	\$455.40	172	\$721.30	207	\$153.45	83	\$574.45	145	\$900.00
20'x20'	25	\$6,835.00	2,190	\$496.80	188	\$769.60	226	\$167.40	90	\$609.40	158	\$1,125.00
20'x24'	30	\$8,255.00	2,630	\$621.00	234	\$952.50	283	\$209.25	113	\$752.25	198	\$1,350.00
24'x32'	48	\$13,019.00	4,180	\$910.80	344	\$1,442.60	415	\$306.90	165	\$1,148.90	290	\$2,160.00
24'x40'	60	\$16,159.00	5,200	\$1,104.00	416	\$1,744.00	504	\$372.00	200	\$1,388.00	352	\$2,700.00
32'x40'	80	\$21,395.00	6,890	\$1,449.00	546	\$2,222.50	661	\$488.25	263	\$1,755.25	462	\$3,600.00
40'x40'	100	\$26,509.00	8,560	\$1,752.60	660	\$2,652.70	800	\$590.55	318	\$2,087.55	559	\$4,500.00
40'x48'	120	\$31,735.00	10,250	\$2,056.20	775	\$3,158.90	938	\$692.85	373	\$2,495.85	656	\$5,400.00
**NOTE: 4" High (no legs) 15" High with 13" Leg 23" High with 21" Leg 23"-30" High with both legs	Includes: 3/4" plywood top on 4'x 4' decks with cam lock			Includes: Additional 30" 1 3/4" legs		Includes: Additional 36" 1 3/4" legs This package uses double braces.		Includes: 24" 1 3/4" and 24" 1 1/2" legs These legs replace those included in the starter package.		Includes: 30" 1 3/4" and 30" 1 1/2" legs These legs replace those included in the starter package. This package uses double braces.		Includes: Gray Carpeted Deck
	Adjustable base foot short											
	2" snap pins											
	4' brace T-handle wrench											



4' x 4' standard deck sizing stacks and stores easily.
3/4" 11 ply exterior with gray finish. Compatible with Signature Stage and Bil-Jax systems.

Roto-locks fasten decks together to form an integrated unit and can be accessed from either the top or bottom of the deck, making it easy to replace a single deck top before or after your staging has been set up.

Deck Capacity - 160 psf

MADE IN  THE USA

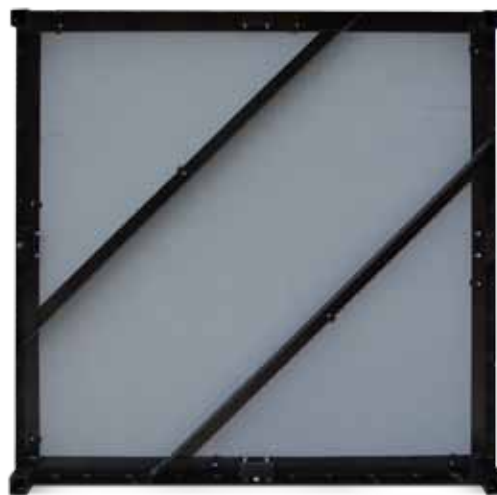

Double "Z" support system.

Description	Cat. No	Item No	Weight	Price
4' X 4' Painted Deck	SL44Z		77 lbs	\$210.00

Additional components for both Signature Stage and ZDex can be found on page 7-11.

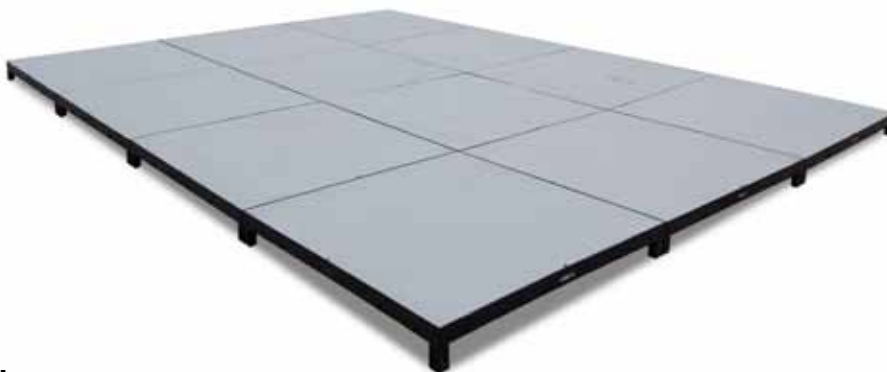

DuraTrac Flooring

4' x 4' lay down flooring is fast and easy to install and remove. Patented side lock system holds panels in place. Slip resistant textured top has even better traction when wet. Reinforced steel supports add higher load capacity. Great for tent flooring or portable walkways. Optional grass pads (not shown) help to protect lawns from wear and tear.



Description	Cat. No	Item No	Weight	Price
4'x4' Deck	DS	85700	57 lbs	\$245.00
4'x4' Deck w/ Grass pads	DSG	85704	60 lbs	\$300.00
4'x4' Deck w/o Steel Reinforcement	DSNT	85706	52 lbs	\$205.00
Hook for moving and installing	DSD	85703	5.25 lbs	\$16.00
4' Ramped Edge Piece	DSRW	85708	----	\$65.00

Stage Legs, Feet & Braces

For use with Signature Staging, ZDex and Axis Aluminum Staging.



The starter and adjustable legs are drilled in 1" increments for easy adjustment and quick assembly. The foot is non-marring with fine adjustment. Unique telescopic leg design offers maximum stage adjustment. The Quik-Connect brace is held in place with only 2 snap pins. The diagonal brace adds stability to any stage and is recommended on stage deck heights above 24".

Description	Cat. No	Item No	Weight	Price
SQUARE GALVANIZED STARTER (OUTSIDE) LEG - 1 3/4"				
6" Leg (Stage Ht, 8")	SS17506	85016	1 lbs	\$4.90
9" (Stage Ht, 11")	SS17509	85098	1.5 lbs	\$5.45
12" (Stage Ht, 14")	SS17512	85017	2 lbs	\$6.00
13" (Stage Ht, 15")	SS17513	85101	2.2 lbs	\$6.65
18" (Stage Ht, 20")	SS17518	85018	3 lbs	\$8.65
24" (Stage Ht, 26")	SS17524	85005	4.2 lbs	\$10.95
30" (Stage Ht, 32")	SS17530	85008	5.2 lbs	\$13.80
36" (Stage Ht, 38")	SS17536	85002	6.3 lbs	\$16.10
48" (Stage Ht, 50")	SS17548	85020	8.4 lbs	\$21.25
SQUARE GALVANIZED (INSIDE) LEG - 1 1/2"				
Used for adjustments. 6" must be retained for connection with starter leg.				
12" (adds up to 6")	SS15012	85003	1.7 lbs	\$5.75
18" (adds up to 12")	SS15018	85014	2.6 lbs	\$8.35
21" (adds up to 15")	SS15021	85102	3 lbs	\$9.00
24" (adds up to 18")	SS15024	85004	3.5 lbs	\$9.35
30" (adds up to 24")	SS15030	85007	4.4 lbs	\$13.50
36" (adds up to 30")	SS15036	85001	5.3 lbs	\$14.45
48" (adds up to 42")	SS15048	85015	7 lbs	\$17.25
ADDITIONAL LEG STOCK - CUT YOUR OWN				
12' (1 3/4" for outside legs)	SS175144	85156	24 lbs	\$58.65
24' (1 3/4" for outside legs)	SS175288	85012	48 lbs	\$113.85
12' (1 1/2" for inside legs)	SS150144	85150	23 lbs	\$52.35
24' (1 1/2" for inside legs)	SS150288	85011	45 lbs	\$103.50
NON-MARING ADJ BASE FOOT (Snap Pins Included)				
Short Stem	SS-BFST	85410	2 lbs	\$15.00
Long Stem	SS-BFL	85093	2 lbs	\$20.00
QUIK-CONNECT DIAGONAL BRACES (Snap Pins Included)				
Starter Brace (gray) For legs with 46" spacing	SS-BR46SD	85270-02	7.5 lbs	\$21.00
Continuous Brace (black) For legs with 48" spacing	SS-BR48D	85236-05	7.5 lbs	\$21.00

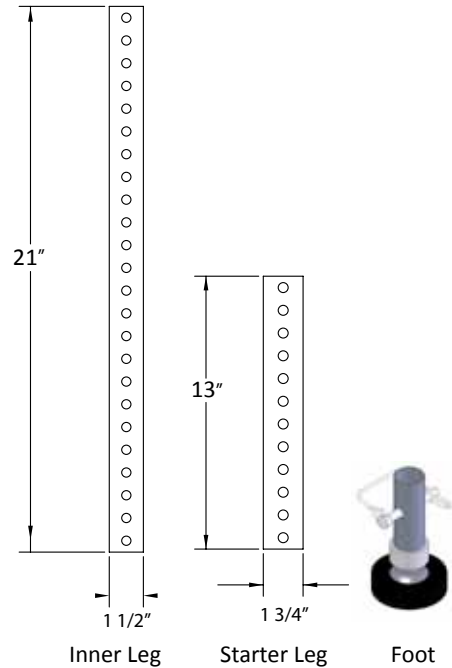

Charts & Tools

For use with Signature Staging and ZDex.

The chart below will help you calculate the number of decks and legs needed for various sized square/rectangular decking. Find the length and width of your decking on the outer most columns and record the quantities where they intersect.

	4'		8'		12'		16'		20'		24'		28'		32'		36'		40'		44'		48'	
	Decks	Legs	Decks	Legs	Decks	Legs	Decks	Legs	Decks	Legs	Decks	Legs	Decks	Legs	Decks	Legs	Decks	Legs	Decks	Legs	Decks	Legs	Decks	Legs
4'	1	4	2	6	3	8	4	10	5	12	6	14	7	16	8	18	9	20	10	22	11	24	12	39
8'	2	6	4	9	6	12	8	15	10	18	12	21	14	24	16	27	18	30	20	33	22	36	24	52
12'	3	8	6	12	9	16	12	20	15	24	18	28	21	32	24	36	27	40	30	44	33	48	36	65
16'	4	10	8	15	12	20	16	25	20	30	24	35	28	40	32	45	36	50	40	55	44	60	48	78
20'	5	12	10	18	15	24	20	30	25	36	30	42	35	48	40	54	45	60	50	66	55	72	60	91
24'	6	14	12	21	18	28	24	35	30	42	36	49	42	56	48	63	54	70	60	77	66	84	72	104
28'	7	16	14	24	21	32	28	40	35	48	42	56	49	64	56	72	63	80	70	88	77	96	84	117
32'	8	18	16	27	24	36	32	45	40	54	48	63	56	72	64	81	72	90	80	99	88	108	96	130
36'	9	20	18	30	27	40	36	50	45	60	54	70	63	80	72	90	81	100	90	110	99	120	108	117
40'	10	22	20	33	30	44	40	55	50	66	60	77	70	88	80	99	90	110	100	121	111	132	120	143

Below is a list of various stage sizes and a recommended number of braces for each.
For stages over 48" high, double the quantity of braces.

Stage Size	Braces
8'x8'	4
12'x12'	8
16'x16'	10
20'x20'	12
24'x24'	16
28'x28'	18
32'x32'	20
36'x36'	24
36'x40'	26
36'x44'	30
36'x48'	32
40'x24'	24
40'x32'	26
40'x40'	28
40'x48'	40

The diagram below gives a top down view of a 16'x16' stage set up. Please note how the legs are placed under each stage.

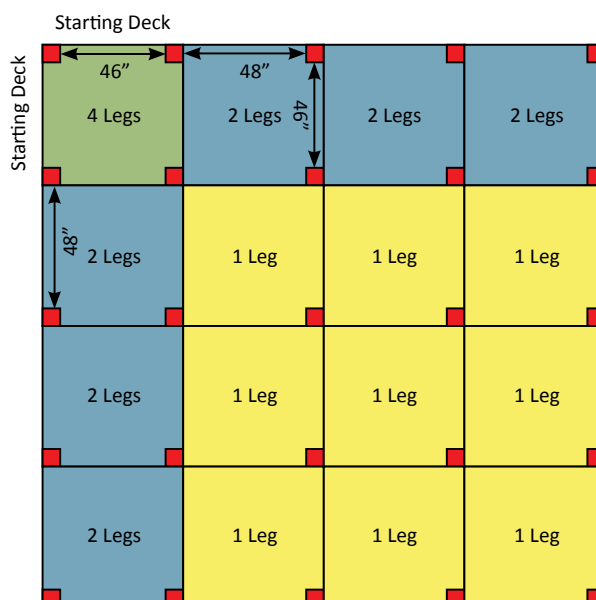



Build-Up Frame

For use with Signature Staging and ZDex.

MADE IN  THE USA

Description	Cat. No	Item No	Weight	Price
48"H Continuous (square tube)	SS-BU4HI	85170-50	28 lbs	\$110.00
48"H Starter (square tube)	SS-BU4HS	85169-50	26 lbs	\$111.00
48" x 24" Diagonal "X" Brace w/bolts for use with square tube build-up frame	SS-B4H24	03079	7 lbs	\$18.00
48"H Continuous (round tube)	SS-BU4TI	85260-05	23 lbs	\$81.50
48"H Starter (round tube)	SS-BU4TS	85261-05	22 lbs	\$82.50
48" / 45-3/4" x 24" Diagonal "X" Brace Double Hole For use with square tube build-up frame	SS-B4/45H24	03153	7 lbs	\$18.50
48" x 24" Panel Brace Double Hole	SS-PBR	85263-05	7 lbs	\$29.00

Additional Parts

For use with Signature Staging and ZDex.

MADE IN  THE USA

Description	Cat. No	Item No	Weight	Price
5/16" T Handle Wrench	SS-TH	85039	1 lbs	\$13.50
5/16" T Handle Wrench with Extended Handle	SS-THEX	85113	2 lbs	\$19.50
2" Snap Pin	SN	06003	0.1 lbs	\$1.00
Deck Screw	SS-DS	PI-01-0050	0.01 lbs	\$0.18
Deck Screw Clip	SS-DSC	PI-01-0051	0.01 lbs	\$0.50
Thumb Screw	SS-TS	PI-01-0052	0.1 lbs	\$1.50
Riser Socket with Hex Nuts	SS-RS	85077	2 lbs	\$13.00
Replacement Roto lock with bolts & nuts	SS-ROTO	85076	1 lbs	\$9.75

Adjustable Stairs

For use with Signature Staging and ZDex.



Most versatile stair on the market. Integrated handles and locking feature make the stairs easy to carry and transport. Stairs fold down to less than 12" tall for storage. Code compliant, when used at recommended stage heights. Handrails included.

Three step Stair Unit (SS-3STR1232) shown.

MADE IN
THE USA 

Description	Cat. No	Item No	Weight	Price
3 Step Package w/Hand Rail Adjustable from 12" to 32"	SS-3STR1232	85204-05	132 lbs	\$649.00
5 Step Package w/Hand Rail Adjustable from 20" to 48"	SS-5STR2048	85206-05	175 lbs	\$889.00
8 Step Package w/Hand Rail Adjustable from 32" to 72"	SS-8STR3272	85205-05	300 lbs	\$1,219.00

Fixed Stairs

For use with Signature Staging, AXIS and ZDex.



Fits Signature Stage, ZDex & AXIS Stage. Works well with any stage 16" - 24" High. No set up time, comes fully assembled.

Description	Cat. No	Item No	Weight	Price
Fixed two step stair. 16" High	SS-STRF2	83115	83 lbs.	\$387.00

Access Ramp

For use with *Signature Staging* and *ZDex*.

Due to the unique design of *Signature Stage*, the use of only a Starter Deck and Connecting Deck permits a ramp of any length to be assembled using standard stage decks to complete it. The angled leg adapter used with regular legs makes this possible. 1" Rise to 12" run. (1:12 pitch). Guard rail packages are available, call factory for details.



MADE IN
THE USA 

Description	Cat. No	Item No	Weight	Price
4'x30" Access Ramp Starter Deck*		85109	68 lbs	\$215.00
4'x12" Access Ramp Connecting Deck*		85110	30 lbs	\$135.00
5"x1¾" Angled Leg Adapter		85111	1.5 lbs	\$9.00
Stage End Hand Rail Section		85367	3.5 lbs	\$25.00
Intermediate Hand Rail Section		85368	25 lbs	\$64.00
Starter Deck End Hand Rail Section		85364R	24.5 lbs	\$69.00
Starter Deck End Hand Rail Section		85364R	24.5 lbs	\$69.00
Hand Rail Starter Mount		85366	7.5 lbs	\$25.00

*Ramp assembly uses standard 4' x 4' decks between the connecting and starter decks.
No special 4' x 4' decks are needed.

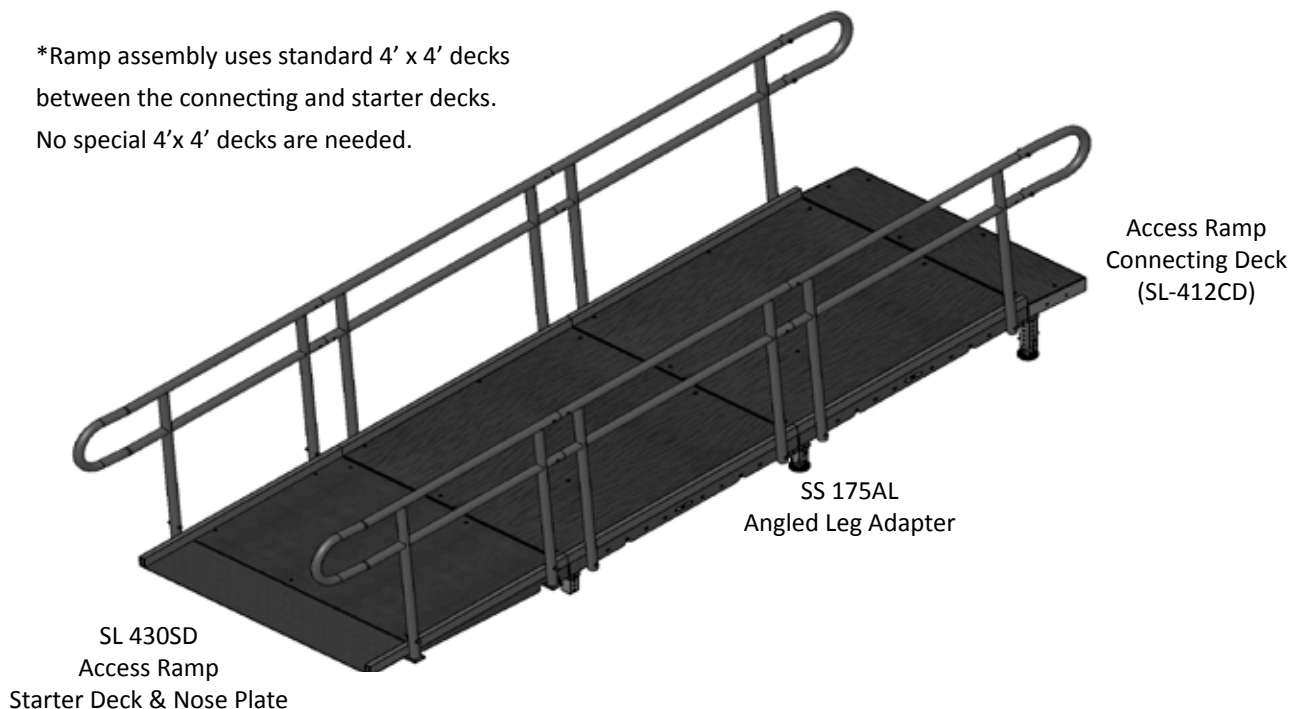

Guard Rails

For use with Signature Staging and ZDex.

MADE IN
THE USA 



3 Rail Horizontal



Half Vertical





SS-SDS



SS-COS



SS-CIS

-  Double Bracket
-  In Line Bracket
-  Offset Bracket

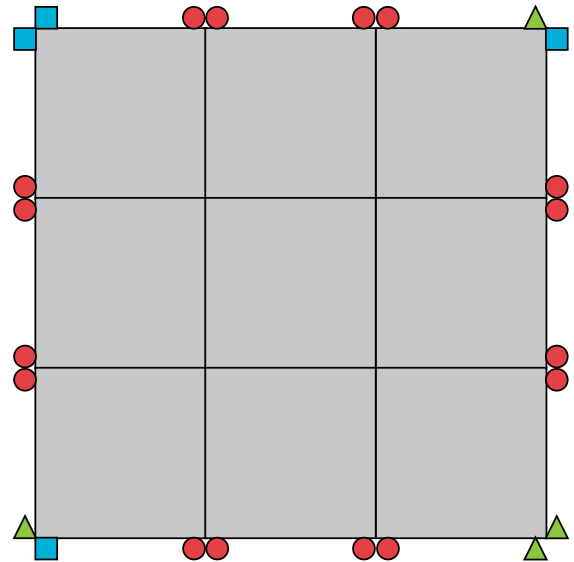

Description	Cat. No	Item No	Weight	Price
GUARD RAIL PANELS - 3 RAIL HORIZONTAL				
4' Horizontal Rails	SS-GRH3-4	85053	19 lbs	\$67.00
8' Horizontal Rails	SS-GRH3-8	85054	34 lbs	\$103.00
GUARD RAIL PANELS - HALF VERTICAL				
4' Half Vertical	SS-GRVH-4	85065	24 lbs	\$98.00
8' Half Vertical	SS-GRVH-8	85066	43 lbs	\$148.00
MOUNTING BRACKETS				
Side Double Socket Bracket (Inc U-Bolt)	SS-SDS	85105	5 lbs	\$18.00
Corner Offset Socket Bracket (Inc U-Bolt)	SS-COS	85106	3 lbs	\$17.50
Corner In Line Socket Bracket	SS-CIS	85107	1 lbs	\$17.25



SS-GRVJ-4
(85334)



SS-GRVJ-2
(85333)

Description	Cat. No	Item No	Weight	Price
GUARD RAIL WITH BUILT IN SOCKETS				
2' Half Vertical Stage Guard Rail Panel	SS-GRVJ-2	85333	15 lbs	\$79.00
4' Half Vertical Stage Guard Rail Panel	SS-GRVJ-4	85334	28 lbs	\$98.00

Multi Mover

All Multi-Movers roll easily for moving bulky items including inflatables, portable toilets, propane tanks, roofing materials, plants, tables, chairs, plus much more. As an added bonus, you'll never have a flat tire again with our closed cell foam tires.

Folding Foot Plate: 17"D x 26"W

MM - Multi-Mover (67004)

10" closed cell foam tires

Outside Wheel Width: 23"

Capacity: 750 lbs. *

Weight: 82 lbs.

\$450.00

MADE IN
THE USA 

3 YEAR LTD
WARRANTY
★★★



Power Multi Mover

100% Electric Powered Cart. 0-2.4mph, heavy duty 13" drive tires, flat free swivel tires, removable rechargeable battery, charger included.

Folding Foot Plate: 17"D x 26"W **Power**

Multi Mover XT (70001)

Turf Tires

Folding Foot Plate: 17"D x 26"W

Level Ground Capacity: 750 lbs.

3:1 Incline Capacity: 500 lbs.

Weight: 150 lbs.

\$1,850.00

MADE IN
THE USA 



Platform Cart

PTW3737-A - 37" x 37"

Dance Floor Platform Truck (67075)

37" x 37" with removable handle

Angle Iron Frame & Handle allow dance floor sections to nest safely onto cart.

Capacity: 660 lbs.

Weight: 35 lbs.

MADE IN
THE USA 

3 YEAR LTD
WARRANTY
★★★



More American Made carts available in our American Cart & Equipment Catalog.

* Capacities listed are when all wheels are being used.



MADE IN
THE USA 

Very lightweight and easy to handle.

Use with our standard legs (page 7) or
FoldX legs (page 14)

Rugged aluminum frame construction
meets IBC Code.

Choice of standard 1/2" painted deck top
or Premium Quad Ripple Laminated.

Premium Quad Ripple Deck



Designed for indoor and outdoor use.

Can be used with multiple leg systems: Square, round,
adjustable and others.

Use as a flat stage, multilevel stage, stage extension, tiered
seating, event platform, display tower, runway, etc.

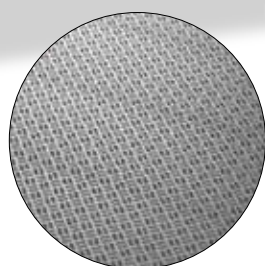

Quad Ripple deck surface

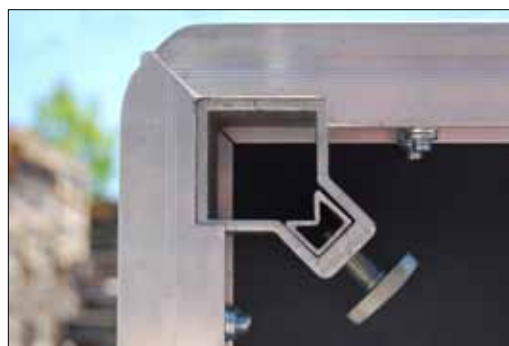

Description	Cat. No	Item No	Weight	Price
4' X 2' Painted Deck	SL-AX24	83002	28 lbs	\$120.00
4' X 4' Painted Deck	SL-AX44	83001	44 lbs	\$187.00
4' x 8' Painted Deck	SL-AX48	83003	88 lbs	\$308.00
4' X 2' Quad Ripple Deck	SL-AX42Q	83012	35 lbs	\$140.00
4' X 4' Quad Ripple Deck	SL-AX44Q	83011	49 lbs	\$225.00
4' x 8' Quad Ripple Deck	SL-AX48Q	83012	88 lbs	\$393.00



Fold X Leg - For AXIS Staging

Extremely rigid, one piece, folding leg system. No bracing required! Only available for Axis Staging.

Can quickly be stacked using inserts and pins.

Stack units up to 6' 6" high.

Available in 1', 2' and 3' heights. Custom sizes available.

Closes for easy storage and transportation.

Quickest leg set up in the industry. Save time, save money!

MADE IN
THE USA 



Shown with
Axis Decking.

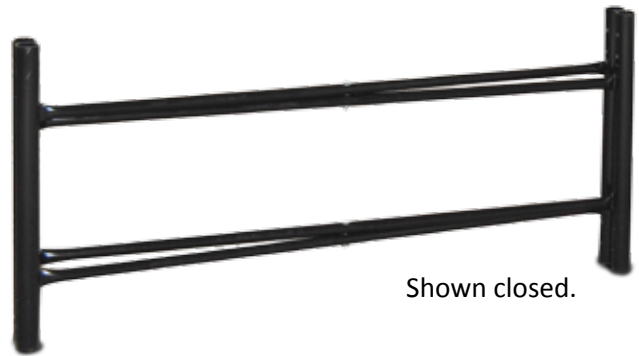

Shown closed.

Description	Cat. No	Item No	Weight	Price
4' x 4' Leg, 12" High	SL-FX11	83051	22 lbs	\$110.00
4' x 4' Leg, 24" High	SL-FX12	83052	27 lbs	\$119.00
4' x 4' Leg, 36" High	SL-FX13	83053	33 lbs	\$129.00

Stair Packages - For AXIS Staging

Description	Cat. No	Item No	Weight	Price
3 Step	SL-AXSTR3	83080	132 lbs	\$619.00
5 Step	SL-AXSTR5	83081	148 lbs	\$799.00
8 Step	SL-AXSTR8	83082	300 lbs	\$1219.00

MADE IN
THE USA 



Guard Rail - For AXIS Staging

Description	Cat. No	Item No	Weight	Price
2' Rail	SL-AXGR2	83070	21 lbs	\$72.00
4' Rail	SL-AXGR4	83071	31 lbs	\$100.00
8' Rail	SL-AXGR8	83072	59 lbs	\$140.00

MADE IN
THE USA 



Additional Parts - For AXIS Staging

Description	Cat. No	Item No	Weight	Price
Connector Sleeve & Bolt	SL-AXCON	83100	.2 lbs	\$3.25
4' Diagonal Brace	SL-AXBR4	83103	4 lbs	\$24.00
Plastic Stage Connector Clip	SL-AXPSC	83112	.25 lbs	\$3.00
Adjustable Foot	SS-BPST	85410	2 lbs	\$14.00
Grass Pin	SL-AXGP	83101	.5 lbs	\$4.00

MADE IN
THE USA 



Diagonal Brace



Plastic Connector Clip



Connector Bolt
& Sleeve



Deluxe Signature Series Bleacher

Includes complete steel understructure, anodized aluminum seat boards and mill finished aluminum footboards, guardrail, double footboards, toeboards on the top 4 rows and aisle with mid-aisle handrail.



*5 Row Deluxe
Signature Series Bleacher*

MADE IN 
THE USA

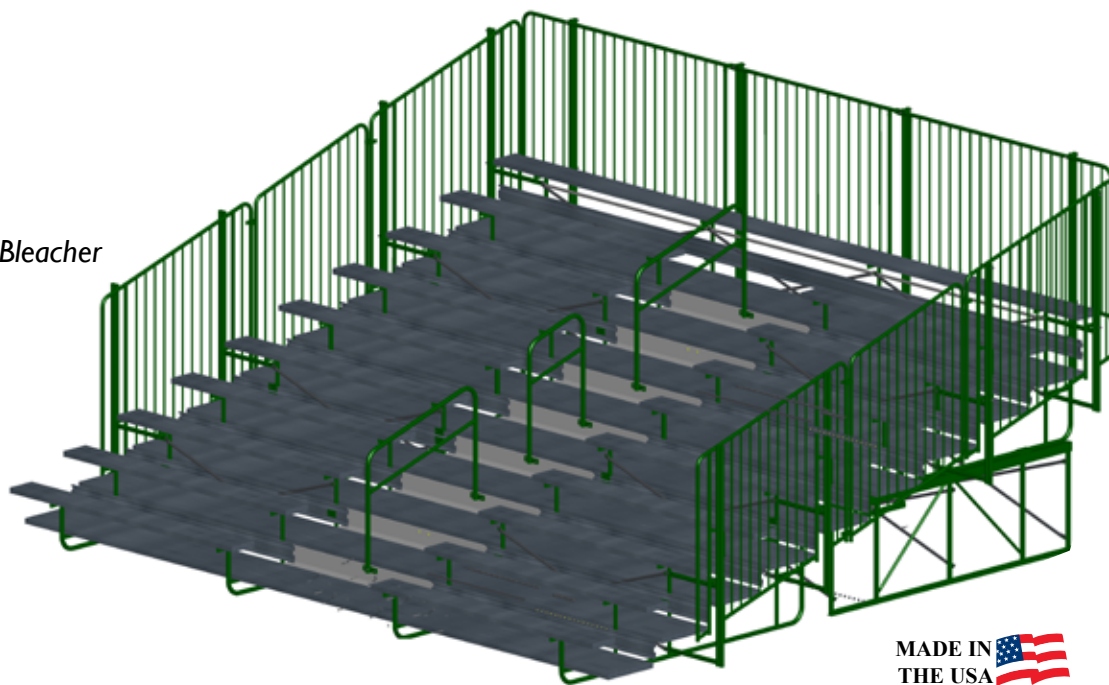

*10 Row Deluxe
Signature Series Bleacher*

MADE IN 
THE USA

Description	Cat. No	Item No	Footprint	Seats	Weight	Price
5 ROW BLEACHERS						
5 Row, 21' Long	ES521ALSDS	90759	21'W x 9'4"D x 7'7"H	54	1,436 lbs	\$6,772.00
5 Row, 27' Long	ES527ALSDS	90778	27'W x 9'4" D x 7'7"H	74	1,810 lbs	\$8,584.00
5 Row, 33' Long	ES533ALSDS	90779	33'W x 9'4"D x 7'7"H	94	2,137 lbs	\$10,004.00
10 ROW BLEACHERS						
10 Row, 21' Long	ES1021ALSDS	90780	21'W x 19'D x 10'7"H	104	3,191 lbs	\$14,771.00
10 Row, 27' Long	ES1027ALSDS	90781	27'W x 19'D x 10'7"H	144	4,008 lbs	\$18,627.00
10 Row, 33' Long	ES1033ALSDS	90782	33'W x 19'D x 10'7"H	184	4,783 lbs	\$21,118.00

Standard Signature Series Bleacher

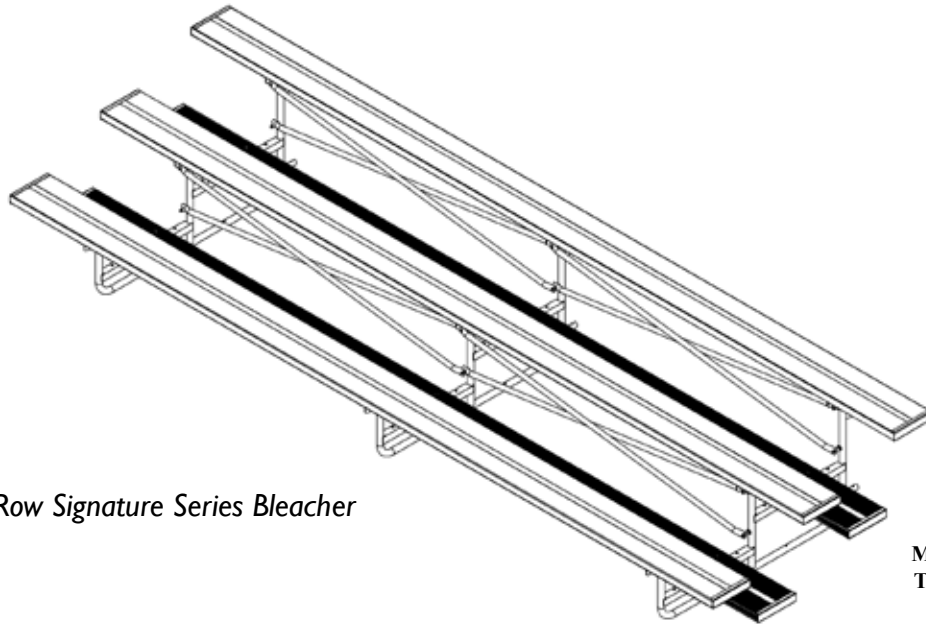

3 Row Signature Series Bleacher

MADE IN
THE USA 

Description	Cat. No	Item No	Footprint	Weight	Seats	Price
3 ROW BLEACHERS						
Includes complete steel understructure, anodized aluminum seat boards and mill finished aluminum footboards.						
3 Row, 9' Long	ES309AL	90662	9'W x 4'8"D x 2'6"H	176 lbs	18	\$970.00
3 Row, 15' Long	ES315AL	90474	15'W x 4'8"D x 2'6"H	277 lbs	30	\$1,481.00
3 Row, 21' Long	ES321AL	90459	21'W x 4'8"D x 2'6"H	385 lbs	42	\$1,896.00
4 ROW BLEACHERS						
Includes complete steel understructure, anodized aluminum seat boards and mill finished aluminum footboards.						
4 Row, 9' Long	ES409AL	90494	9'W x 6'7"D x 2'6"H	245 lbs	24	\$1,321.00
4 Row, 15' Long	ES415AL	90464	15'W x 6'7"D x 2'6"H	395 lbs	40	\$2,008.00
4 Row, 21' Long	ES421AL	90645	21'W x 6'7"D x 2'6"H	546 lbs	56	\$2,561.00
5 ROW BLEACHERS						
Includes guardrail, double footboards and toeboards on the top 2 rows.						
5 Row, 9' Long	ES509AG	90785	9'W x 9'4"D x 7'7"H	622 lbs	30	\$2,943.00
5 Row, 15' Long	ES515AG	90786	15'W x 9'4"D x 7'7"H	943 lbs	50	\$4,428.00
5 Row, 21' Long	ES521AG	90787	21'W x 9'4"D x 7'7"H	1,221 lbs	65	\$5,533.00
3 ROW UNDERSTRUCTURE ONLY						
Customer supplies seatboards, footboards and guardrails.						
3 Row, 6' Long	ES306TM	90304		62 lbs	18	\$218.00
3 Row, 12' Long	ES312TM	90305		102 lbs	30	\$350.00
3 Row, 18' Long	ES318TM	90306		142 lbs	42	\$482.00
4 ROW UNDERSTRUCTURE ONLY						
Customer supplies seatboards, footboards and guardrails.						
4 Row, 6' Long	ES406TM	90309		94 lbs	24	\$274.00
4 Row, 12' Long	ES412TM	90310		118 lbs	40	\$480.00
4 Row, 18' Long	ES418TM	90311		206 lbs	56	\$594.00
5 ROW UNDERSTRUCTURE ONLY						
Customer supplies seatboards, footboards and guardrails.						
5 Row, 6' Long	ES506TM	90237		114 lbs	30	\$386.00
5 Row, 12' Long	ES512TM	90238		180 lbs	50	\$602.00
5 Row, 18' Long	ES518TM	90239		240 lbs	65	\$818.00

Fold-N-Tow Bleacher



Fold-N-Tow 103 pictured

Trailer has tandem axle, 7 pin adapter & electric brakes. Only requires 1 person to set up or tear down in 15 minutes or less. Can be towed with a 1/2 ton pickup truck.

Fold-N-Tow 72

- 19' Bleacher (25' Long Overall)
- Center aisle comes with detachable hand rails that store on the back of the trailer.
- Easily folds up into 3 sections.

Fold-N-Tow 107

- 26.5' Bleacher (32.5' Long Overall)
- Aisle comes with detachable hand rails that store on the back of the trailer.
- Easily folds up into 4 sections.



Fold-N-Tow 72 pictured



Easy 1 Person Set-Up.



Fold-N-Tow 72 Pictured

Description	Cat. No	Item No	Seats	Dimensions	Weight	Price
Fold-N-Tow 72	BLST-FNT72	90836	72	9' 6" H x 8' W (13' W seating position) x 25'L	3200 lbs	\$14,995
Fold-N-Tow 107	BLST-FNT107	90882	107	9' 6" H x 8' W (13' W seating position) x 32' 6"L	4600 lbs	\$17,995

Team Benches

Available in 7.5', 9' and 15' Lengths. Anodized Aluminum Bench with powder coated steel understructure.
Available as bench only, bench with back or bench with back and shelf.



MADE IN
THE USA 

Team Bench

MADE IN
THE USA 



Wide Team Bench



MADE IN
THE USA 

Team bench with Back



MADE IN
THE USA 

Team Bench with Back and Shelf

Description	Cat. No	Item No	Weight	Price
7' 6" Alluminum Seat Park Bench	PBNB76	75043-05	33 lbs	\$189.00
15' Alluminum Seat Park Bench	PBNB15	75044-05	46 lbs	\$349.00
7' 6" Alluminum Seat Team Bench w/ Back	PBWB76	75050	47 lbs	\$329.00
15' Alluminum Seat Team Bench w/ Back	PBWB15	75060-01	80 lbs	\$599.00
9' Alluminum Seat Team Bench w/ Back & Shelf	PBWS09	75085-05	107 lbs	\$479.00
15' Alluminum Seat Team Bench w/ Back & Shelf	PBWS15	75083-05	148 lbs	\$689.00

Picnic Tables



MADE IN
THE USA 

Pre galvanized frame (1" 5/8 Tubing) with aluminum seating and top. 10" wide aluminum plank.

Description	Cat. No	Item No	Weight	Price
8' long	PTHD8	75049	140 lbs	\$995.00
6' long	PTHD6		130 lbs	\$945.00
Frame & Hardware only	PTHD-HW	75046	55 lbs	\$145.00

Mobile Scoring Table



Serves as a scoring center, statician center or other elevated table depending on the sport or activity. Fully portable, easy to move. Seats five to six people comfortably. Anodized aluminum bench slides forward and back for easy access to the 12" deep scorer's table. Dimensions are 11'H x 7'W x 11'L.

Standard vinyl canopy included, call us for color options. Custom banner not included.

MADE IN
THE USA 

Description	Cat. No	Item No	Weight	Price
Mobile Scoring Table	BL-PORTABLE	75101	1,200 lbs	\$12,984.00

Crowd Control Fencing



Foot Styles: Flat, Wide Arch and Narrow Arch.

Description	Cat. No	Item No	Weight	Price
8'x44" Fencing Section (Feet Not Included)	F-8-G-150	50015-50	43 lbs	\$110.00
Wide Arch Base Foot	F-BFW-G-150	50017-50	3 lbs	\$18.00
Narrow Arch Base Foot	F-BFN-G-150	50018-50	3 lbs	\$18.00
Flat Base Foot	F-BFL-G-150	50019-50	4 lbs	\$18.00

Black Tie Fencing



Step away from dull, boring crowd control fencing with our new Black Tie line. The gloss black finish and new styling gives this fencing a more polished, higher end look. Be sure you have a Black Tie for your next special event.

MADE IN
THE USA



Description	Cat. No	Item No	Weight	Price
Black Tie Fence 8'Lg	F-BT-8-()	50037-()	53 lbs	\$165.00
Black Wide Arch Base Foot	F-BFW-B-()	50017-()	3 lbs	\$24.00
Black Narrow Arch Base Foot	F-BFN-B-()	50018-()	3 lbs	\$24.00
Black Flat Base Foot	F-BFL-B-()	50019-()	4 lbs	\$24.00

* () Specify Color Code

Stackable Table/Chair Storage Cart

Stack up to 3 high. Each unit has 2 sets of fork pockets, and 5" swivel casters. Legs remove to make loading and unloading tables & chairs easier. 36" W (31" Inside) x 60" W. **Holds the following items:** 6' and 8' long banquet tables, 5' round tables, 3 stacks of folding chairs (*Add plywood)

TRC3660S - Table Storage Cart w/ 33" Legs (67136)

Capacity: 1500 lbs.

Weight: 140 lbs.

\$510.00

TRC3660L - Table Storage Cart w/ 66" Legs (67038)

Capacity: 1500 lbs.

Weight: 171 lbs.

Holds up to 150 Samsonite Style Folding Chairs or up to 75 Resin Folding Chairs.

\$585.00

MADE IN
THE USA



3 YEAR LTD
WARRANTY



All legs/poles are removable to make loading and unloading tables & chairs easier.



Table Carts

PTRT2440 - Round Table Cart (67120)

Holds up to Five (5) 5' Round Tables

Capacity: 350 lbs.

Weight: 60 lbs.

\$245.00

PTRECT2440 - Rectangle Table Cart (67121)

Holds up to Six (6) 8' Long Rectangle Tables

Capacity: 350 lbs.

Weight: 61 lbs.

\$252.00

MADE IN
THE USA



3 YEAR LTD
WARRANTY



Chiavari Chair Cart

Specifically designed to move up to 5 Chiavari Chairs at once. Arm folds up and out of the way to convert to a standard hand truck.

HT-CT - Chiavari Chair Cart (67164)

Capacity: 5 Chiavari Chairs

Weight: 50 lbs.

\$182.00

FLAT FREE
TIRES

MADE IN
THE USA



3 YEAR LTD
WARRANTY

